

CR-C & CR-XC

Crowned • Regular Stud

Screwdriver Slot

Regular Stud
with Crowned Outer Race
Screw-Driver Slot
Sealed or Unsealed
X = Sealed

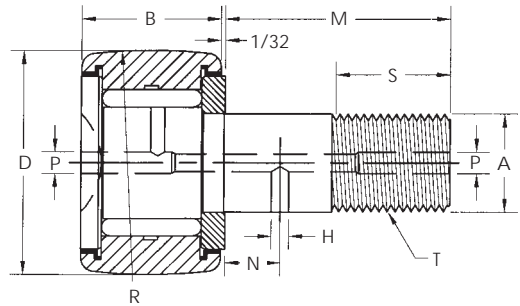

Dimensional Data (inches)

SMITH Bearing® Number		D Roller O.D. +.000 -.001	B Roller Width +.000 -.005	A Stud Dia. +.001 -.000	M Stud Length	S Eff. Thread Min.	T Thread U.N.F. Class 2A	N Oil Hole Location	H Oil Hole Dia.	P Lube Fitting Size	Min. Boss. Dia.	Recom. Bore +.0005 -.0000	Recom. Torque (lbs-in)	Basic Dynamic Rating (lbs)	Max Static Capacity (lbs)	R Crown Radius (Inches)
UNSEALED	SEALED															
CR-1/2A-C	CR-1/2A-XC	.500	.3440		1/2									870		
CR-1/2-C	CR-1/2-XC	.500	.3750	.190	5/8	1/4	10-32	-	-	*1/8	19/64	.1900	20	970	720	7
CR-9/16-C	CR-9/16-XC	.5625														
CR-5/8A-C	CR-5/8A-XC	.625	.4060		5/8									1210		
CR-5/8-C	CR-5/8-XC	.625	.4375	.250	3/4	5/16	1/4-28	-	-	*1/8	23/64	.2500	50	1320	1250	8
CR-11/16-C	CR-11/16-XC	.6875														
CR-3/4-C	CR-3/4-XC	.750	.5000	.375	7/8	3/8	3/8-24	1/4	3/32	3/16	1/2	.3750	120	2140	2200	10
CR-7/8-C	CR-7/8-XC	.875														
CR-1-C	CR-1-XC	1.000	.6250	.4375	1	1/2	7/16-20	1/4	3/32	3/16	5/8	.4375	350	3030	3100	12
CR-1 1/8-C	CR-1 1/8-XC	1.125														
CR-1 1/4-C	CR-1 1/4-XC	1.250	.7500	.500	1-1/4	5/8	1/2-20	5/16	3/32	3/16	3/4	.5000	500	4470	4300	14
CR-1 3/8-C	CR-1 3/8-XC	1.375														
CR-1 1/2-C	CR-1 1/2-XC	1.500	.8750	.625	1-1/2	3/4	5/8-18	3/8	3/32	3/16	57/64	.6250	1000	5560	5730	20
CR-1 5/8-C	CR-1 5/8-XC	1.625														
CR-1 3/4-C	CR-1 3/4-XC	1.750	1.0000	.750	1 3/4	7/8	3/4-16	7/16	3/32	3/16	1 3/64	.7500	2000	7870	7950	20
CR-1 7/8-C	CR-1 7/8-XC	1.875														
CR-2-C	CR-2-XC	2.000	1.2500	.875	2	1	7/8-14	1/2	5/32	3/16	1 13/64	.8750	2200	10370	10700	24
CR-2 1/4-C	CR-2 1/4-XC	2.250														
CR-2 1/2-C	CR-2 1/2-XC	2.500	1.5000	1.000	2 1/4	1 1/8	1-14	9/16	5/32	3/16	1 5/16	1.0000	3000	15280	16650	30
CR-2 3/4-C	CR-2 3/4-XC	2.750														
CR-3-C	CR-3-XC	3.000	1.7500	1.250	2 1/2	1 1/4	1 1/4-12	5/8	1/4	1/4	1 3/4	1.2500	5000	20200	25200	30
CR-3 1/4-C	CR-3 1/4-XC	3.250														
CR-3 1/2-C	CR-3 1/2-XC	3.500	2.0000	1.375	2 3/4	1 3/8	1 3/8-12	11/16	1/4	1/4	2	1.3750	6000	29660	31800	30
CR-4-C	CR-4-XC	4.000	2.2500	1.500	3 1/2	1 1/2	1 1/2-12	3/4	1/4	1/4	2 1/4	1.5000	7000	35980	45100	30
	CR-5-XBC	Available only in Hex Hole Configuration.														
	CR-6-XBC															

* Relubricate through head end only.