

HR & HR-X

Heavy Stud

Screwdriver Slot

Heavy Stud with
Screw-Driver Slot
Sealed or Unsealed
X = Sealed

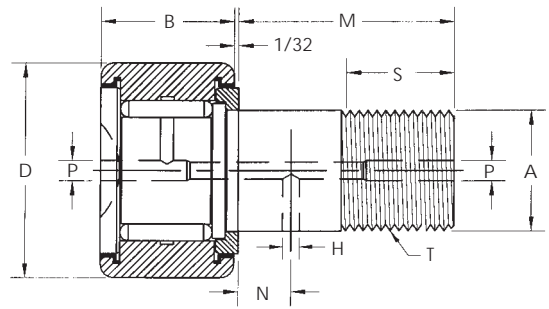

Dimensional Data (inches)

SMITH Bearing® Number		D Roller O.D. +.000 -.001	B Roller Width +.000 -.005	A Stud Dia. +.001 -.000	M Stud Length	S Eff. Thread Min.	T Thread U.N.F. Class 2A	N Oil Hole Location	H Oil Hole Dia.	P Lube Fitting Size	Min Boss. Dia.	Recom. Bore +.0005 -.0000	Recom. Torque (lbs-in)	Basic Dynamic Rating (lbs)	Max Static Capacity (lbs)
UNSEALED	SEALED														
HR-1/2	HR-1/2-X	.500	.375	.250	5/8	1/4	1/4-28	-	-	*1/8	19/64	.2500	50	970	1590
HR-5/8	HR-5/8-X	.625	.437	.3125	3/4	5/16	5/16-24	-	-	*1/8	23/64	.3125	75	1210	2500
HR-3/4	HR-3/4-X	.750	.500	.4375	7/8	3/8	7/16-20	1/4	3/32	3/16	1/2	.4375	300	2140	4150
HR-7/8	HR-7/8-X	.875		.625	1	1/2	5/8-18	1/4	3/32	3/16	3/4	.6250	500	2850	6200
HR-1	HR-1-X	1.000	.750	.750	1 1/4	5/8	3/4-16	5/16	3/32	3/16	7/8	.7500	1000	4060	8600
HR-1 1/8	HR-1 1/8-X	1.125		.875	1 1/2	3/4	7/8-14	3/8	3/32	3/16	15/16	.8750	2000	5330	11300
HR-1 1/4	HR-1 1/4-X	1.250	1.000	1.000	1 3/4	7/8	1-14	7/16	3/32	3/16	1 3/32	1.0000	2500	7600	15870
HR-1 3/8	HR-1 3/8-X	1.375		1.125	2	1	1 1/8-12	1/2	5/32	3/16	1 7/32	1.1250	3000	10050	22000
HR-1 1/2	HR-1 1/2-X	1.500	1.500	1.250	2 1/4	1 1/8	1 1/4-12	9/16	5/32	3/16	1 5/16	1.2500	4000	15280	33000
HR-1 5/8	HR-1 5/8-X	1.625		1.500	2 1/2	1 1/4	1 1/2-12	5/8	5/32	1/4	1 3/4	1.5000	5000	20200	49900
HR-1 3/4	HR-1 3/4-X	1.750	2.000	1.750	2 3/4	1 3/8	1 3/4-12	11/16	5/32	1/4	1 15/16	1.7500	6000	29660	63300
HR-1 7/8	HR-1 7/8-X	1.875		2.000	3 1/2	1 1/2	2-12	3/4	5/32	1/4	2 1/4	2.0000	8000	35980	90000

* Relubricate through head end only.