

MUTD

Double Row • Heavy Rollers

Yoke Type

Shielded • Full Complement

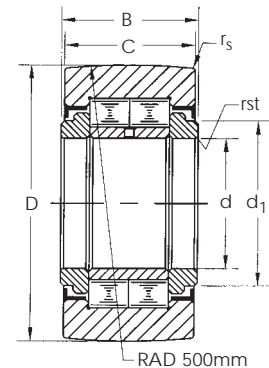

SMITH Bearing® Number	Dimensions (mm) (For Tolerances, See chart in Engineering Section)							Basic Load Ratings				Max Speed* (rpm)	Mass (grams)
								dyn Newtons		stat Newtons			
	d	D	B	C**	r _s	rst	d ₁	C	C ₀	C _w	C _{ow}		
MUTD-15	15	35	19	18	0.6	0.3	20	23,000	27,000	16,000	18,300	6,500	99
MUTD-17	17	40	21	20	1	0.3	22	24,800	31,000	18,500	22,800	5,500	147
MUTD-1542	15	42	19	18	0.6	0.3	20	23,000	27,000	19,400	23,800	6,500	158
MUTD-1747	17	47	21	20	1	0.3	22	24,800	31,000	21,300	28,000	5,500	220
MUTD-20	20	47	25	24	1	0.3	27	39,000	50,000	28,000	35,000	4,200	245
MUTD-2052	20	52	25	24	1	0.3	27	39,000	50,000	31,500	41,000	4,200	321
MUTD-25	25	52	25	24	1	0.3	31	43,500	60,000	29,000	37,500	3,400	281
MUTD-2562	25	62	25	24	1	0.3	31	43,500	60,000	35,500	50,000	3,400	450
MUTD-30	30	62	29	28	1	0.3	38	59,000	79,000	40,000	51,000	2,600	465
MUTD-3072	30	72	29	28	1	0.3	38	59,000	79,000	48,000	65,000	2,600	697
MUTD-35	35	72	29	28	1.1	0.6	44	65,000	93,000	45,000	61,000	2,100	630
MUTD-3580	35	80	29	28	1.1	0.6	44	65,000	93,000	51,000	72,000	2,100	836
MUTD-40	40	80	32	30	1.1	0.6	51	90,000	134,000	56,000	76,000	1,600	816
MUTD-45	45	85	32	30	1.1	0.6	55	95,000	147,000	56,000	79,000	1,400	883
MUTD-4090	40	90	32	30	1.1	0.6	51	90,000	134,000	66,000	96,000	1,600	1,129
MUTD-50	50	90	32	30	1.1	0.6	60	100,000	161,000	57,000	81,000	1,300	950
MUTD-45100	45	100	32	30	1.1	0.6	55	95,000	147,000	72,000	108,000	1,400	1,396
MUTD-50110	50	110	32	30	1.1	0.6	60	100,000	161,000	76,000	121,000	1,300	1,690

- 1) The basic load rating C and C₀ apply if the bearing outer ring (with cylindrical outside surface) is mounted in a housing bore with the normal rolling bearing fit. When used as a track roller, the load rating C_w and C_{ow} apply.
- 2) Standard bearing has **Crowned Roller Outside Diameter** – For **Straight Cylindrical Outside Roller Diameter**, add suffix "C." Example: **MUTD-15-C**
- 3) *Limiting Speed is given for a lightly loaded bearing with oil lubrication.
- 4) ** Tolerance for "C" Raceway Width is +0.00/-0.12 mm

INTERCHANGE TABLE

Double Row • Heavy Rollers
Shielded • Full Complement

SMITH®	McGILL	INA
MUTD-15	MCYRD-15	NUTR-15
MUTD-17	MCYRD-17	NUTR-17
MUTD-1542	MCYRD-1542	NUTR-1542
MUTD-1747	MCYRD-1747	NUTR-1747
MUTD-20	MCYRD-20	NUTR-20
MUTD-2052	MCYRD-2052	NUTR-2052
MUTD-25	MCYRD-25	NUTR-25
MUTD-2562	MCYRD-2562	NUTR-2562
MUTD-30	MCYRD-30	NUTR-30
MUTD-3072	MCYRD-3072	NUTR-3072
MUTD-35	MCYRD-35	NUTR-35
MUTD-3580	MCYRD-3580	NUTR-3580
MUTD-40	MCYRD-40	NUTR-40
MUTD-45	MCYRD-45	NUTR-45
MUTD-4090	MCYRD-4090	NUTR-4090
MUTD-50	MCYRD-50	NUTR-50
MUTD-45100	MCYRD-45100	NUTR-45100
MUTD-50110	MCYRD-50110	NUTR-50110